

Sun Disk Shelf-24x3.5" SAS-2

SIM Board Replacement Guide



Part No.: 820-7244-12
March 2012

Copyright © 2010, 2012, Oracle and/or its affiliates. All rights reserved.

This software and related documentation are provided under a license agreement containing restrictions on use and disclosure and are protected by intellectual property laws. Except as expressly permitted in your license agreement or allowed by law, you may not use, copy, reproduce, translate, broadcast, modify, license, transmit, distribute, exhibit, perform, publish, or display any part, in any form, or by any means. Reverse engineering, disassembly, or decompilation of this software, unless required by law for interoperability, is prohibited.

The information contained herein is subject to change without notice and is not warranted to be error-free. If you find any errors, please report them to us in writing.

If this is software or related software documentation that is delivered to the U.S. Government or anyone licensing it on behalf of the U.S. Government, the following notice is applicable:

U.S. GOVERNMENT END USERS. Oracle programs, including any operating system, integrated software, any programs installed on the hardware, and/or documentation, delivered to U.S. Government end users are "commercial computer software" pursuant to the applicable Federal Acquisition Regulation and agency-specific supplemental regulations. As such, use, duplication, disclosure, modification, and adaptation of the programs, including any operating system, integrated software, any programs installed on the hardware, and/or documentation, shall be subject to license terms and license restrictions applicable to the programs. No other rights are granted to the U.S. Government.

This software or hardware is developed for general use in a variety of information management applications. It is not developed or intended for use in any inherently dangerous applications, including applications that may create a risk of personal injury. If you use this software or hardware in dangerous applications, then you shall be responsible to take all appropriate fail-safe, backup, redundancy, and other measures to ensure its safe use. Oracle Corporation and its affiliates disclaim any liability for any damages caused by use of this software or hardware in dangerous applications.

Oracle and Java are registered trademarks of Oracle and/or its affiliates. Other names may be trademarks of their respective owners.

Intel and Intel Xeon are trademarks or registered trademarks of Intel Corporation. All SPARC trademarks are used under license and are trademarks or registered trademarks of SPARC International, Inc. AMD, Opteron, the AMD logo, and the AMD Opteron logo are trademarks or registered trademarks of Advanced Micro Devices. UNIX is a registered trademark of The Open Group.

This software or hardware and documentation may provide access to or information on content, products, and services from third parties. Oracle Corporation and its affiliates are not responsible for and expressly disclaim all warranties of any kind with respect to third-party content, products, and services. Oracle Corporation and its affiliates will not be responsible for any loss, costs, or damages incurred due to your access to or use of third-party content, products, or services.

Copyright © 2010, 2012, Oracle et/ou ses affiliés. Tous droits réservés.

Ce logiciel et la documentation qui l'accompagne sont protégés par les lois sur la propriété intellectuelle. Ils sont concédés sous licence et soumis à des restrictions d'utilisation et de divulgation. Sauf disposition de votre contrat de licence ou de la loi, vous ne pouvez pas copier, reproduire, traduire, diffuser, modifier, breveter, transmettre, distribuer, exposer, exécuter, publier ou afficher le logiciel, même partiellement, sous quelque forme et par quelque procédé que ce soit. Par ailleurs, il est interdit de procéder à toute ingénierie inverse du logiciel, de le désassembler ou de le décompiler, excepté à des fins d'interopérabilité avec des logiciels tiers ou tel que prescrit par la loi.

Les informations fournies dans ce document sont susceptibles de modification sans préavis. Par ailleurs, Oracle Corporation ne garantit pas qu'elles soient exemptes d'erreurs et vous invite, le cas échéant, à lui en faire part par écrit.

Si ce logiciel, ou la documentation qui l'accompagne, est concédé sous licence au Gouvernement des Etats-Unis, ou à toute entité qui délivre la licence de ce logiciel ou l'utilise pour le compte du Gouvernement des Etats-Unis, la notice suivante s'applique :

U.S. GOVERNMENT END USERS. Oracle programs, including any operating system, integrated software, any programs installed on the hardware, and/or documentation, delivered to U.S. Government end users are "commercial computer software" pursuant to the applicable Federal Acquisition Regulation and agency-specific supplemental regulations. As such, use, duplication, disclosure, modification, and adaptation of the programs, including any operating system, integrated software, any programs installed on the hardware, and/or documentation, shall be subject to license terms and license restrictions applicable to the programs. No other rights are granted to the U.S. Government.

Ce logiciel ou matériel a été développé pour un usage général dans le cadre d'applications de gestion des informations. Ce logiciel ou matériel n'est pas conçu ni n'est destiné à être utilisé dans des applications à risque, notamment dans des applications pouvant causer des dommages corporels. Si vous utilisez ce logiciel ou matériel dans le cadre d'applications dangereuses, il est de votre responsabilité de prendre toutes les mesures de secours, de sauvegarde, de redondance et autres mesures nécessaires à son utilisation dans des conditions optimales de sécurité. Oracle Corporation et ses affiliés déclinent toute responsabilité quant aux dommages causés par l'utilisation de ce logiciel ou matériel pour ce type d'applications.

Oracle et Java sont des marques déposées d'Oracle Corporation et/ou de ses affiliés. Tout autre nom mentionné peut correspondre à des marques appartenant à d'autres propriétaires qu'Oracle.

Intel et Intel Xeon sont des marques ou des marques déposées d'Intel Corporation. Toutes les marques SPARC sont utilisées sous licence et sont des marques ou des marques déposées de SPARC International, Inc. AMD, Opteron, le logo AMD et le logo AMD Opteron sont des marques ou des marques déposées d'Advanced Micro Devices. UNIX est une marque déposée d'The Open Group.

Ce logiciel ou matériel et la documentation qui l'accompagne peuvent fournir des informations ou des liens donnant accès à des contenus, des produits et des services émanant de tiers. Oracle Corporation et ses affiliés déclinent toute responsabilité ou garantie expresse quant aux contenus, produits ou services émanant de tiers. En aucun cas, Oracle Corporation et ses affiliés ne sauraient être tenus pour responsables des pertes subies, des coûts occasionnés ou des dommages causés par l'accès à des contenus, produits ou services tiers, ou à leur utilisation.



Contents

Replacing a SIM Board 1

ESD Precautions 1

SIM Board Components 3

Procedure 5

- ▼ To Remove the Failed SIM Board 5
- ▼ To Install the New SIM Board 7
- ▼ To Verify the SIM Board Replacement 8

Replacing a SIM Board

This document describes how to replace the SAS Interface Module (SIM) in the Sun Disk Shelf-24x3.5" SAS-2.



Caution – Only trained service personnel should remove the covers on this equipment.

This product is intended for restricted access, whereby access is controlled through the use of a means of security (for example, key, lock, tool, badge access) and personnel authorized for access have been instructed on the reasons for the restrictions and any precautions that they need to take.

This document assumes that you have:

- Identified the chassis containing the failed SIM board.
- Received the replacement SIM board.

ESD Precautions

When performing this service action, observe the following electrostatic discharge (ESD) precautions:

- Remove all plastic, vinyl, and foam material from the work area.
- Wear an antistatic wrist strap at all times when handling any component.
- Before handling any component, discharge any static electricity by touching a grounded surface.
- Do not remove a component from its antistatic protective bag until you are ready to install it.

- After removing a component from the chassis, immediately place it on an antistatic surface or in antistatic packaging.
- Handle any card that is part of a component only by its edges and avoid touching the components or circuitry.
- Do not slide a component over any surface.
- Limit body movement (which builds up static electricity) during the removal and replacement of a component.

SIM Board Components

FIGURE 1 illustrates the location of the SIM board components and LEDs.

FIGURE 1 SIM Board Components and LEDs

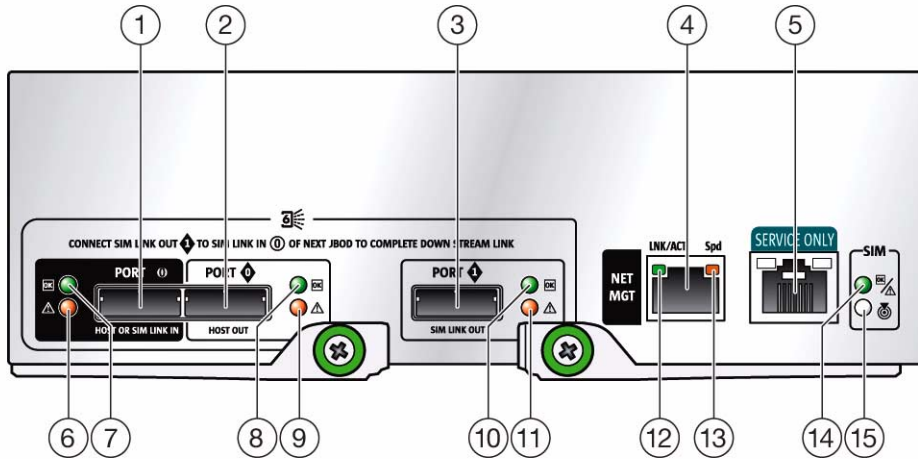

Figure Legend

- 1 Host or SIM Link In
- 2 Host Out
- 3 SIM Link Out
- 4 Network management port
- 5 For service only
- 6 Host or SIM Link In port fault LED
- 7 Host or SIM Link In port OK LED
- 8 Host Out port OK LED
- 9 Host Out port fault LED
- 10 SIM Link In port OK LED
- 11 SIM Link In port fault LED
- 12 Network management port active LED
- 13 Network management port speed LED (amber on indicates 100 megabits per second; amber off indicates 10 megabits per second)
- 14 SIM board OK LED (green)/SIM board fault LED (amber)
- 15 SIM locator LED

Procedure

To replace a failed SIM board, you must complete the following steps, which are explained in detail in the remainder of this guide:

1. Remove the failed SIM board. See [“To Remove the Failed SIM Board”](#) on page 4.
2. Install the replacement SIM board. See [“To Install the New SIM Board”](#) on page 6.
3. Verify the installation. See [“To Verify the SIM Board Replacement”](#) on page 7.



Caution – Potential loss of data access. If any of the port LEDs on the SIM board (FIGURE 1) are blinking, there is data actively moving in and out of the disk shelf. If you remove the SIM, data might be lost.



Caution – Electrical shock hazard. The power supplies in this equipment can produce high energy hazards. Only trained personnel with authorized access to this equipment should remove and replace modules in the system.

Note – The SIM boards are hot-swappable. You do not need to disconnect power from the system or other components in order to replace one of these components.

▼ To Remove the Failed SIM Board

1. From the back of the chassis, locate the failed SIM.
2. Label each mini-SAS cable connection for reconnection to the same connectors on the replacement chassis.
For example, Disk Shelf 1, SIM Link Out to Disk Shelf 0, Host or SIM Link In.
3. Disconnect the labeled mini-SAS cables from each SIM board:
 - a. Grasp the metal body of the connector with one hand, and use your other hand to firmly grasp and pull the tab.
 - b. Pull the tab gently toward the connector body, and then with your other hand, extract the connector from the chassis.



Caution – Do not twist or pull the tab in any direction other than parallel with the connector body or you might break the tab. If the tab breaks, use a small sharp object (such as a fine-tipped screwdriver) to lift the metal spring at the top of the connector shell to unlatch it.

4. Remove the SIM board from the chassis (FIGURE 2):

- a. Loosen the two captive screws on the ejection levers and pull the ejection levers fully out to partially eject the SIM board from the chassis.**

If the captive screws are too tight to loosen by hand, use a Phillips No. 2 screwdriver to loosen each screw.

- b. Pull the SIM board from the chassis.**

5. Place the SIM board aside on an antistatic surface or in antistatic packaging.

FIGURE 2 Removing a SIM Board

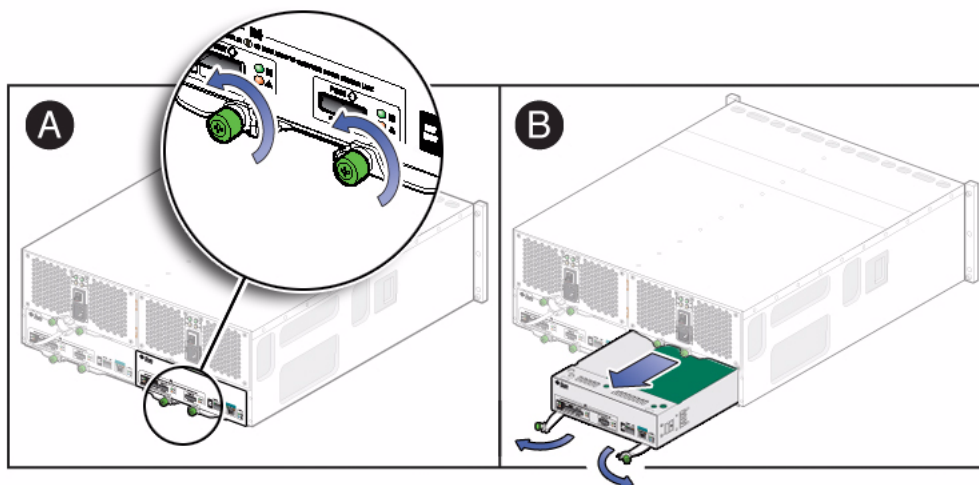

Caution – Use care when handling either the new or failed SIM board. Ensure that all ESD precautions are being followed.

▼ To Install the New SIM Board

1. Unpack the new SIM board.
2. Place the failed SIM board in the packing materials so that you can return it to Oracle for proper disposal.
3. Insert the new SIM board into the back of the chassis (FIGURE 3):
 - a. Swing both SIM board ejection levers to the fully open position.
 - b. Align the SIM board with the open slot and slide it into the chassis until it engages with the chassis connectors and the ejection levers begin to swing closed.

Note – If the SIM board does not fit into the slot, check that you have the correct SIM board for this system.

- c. Simultaneously push both ejection levers toward the middle of the board to seat it in the chassis.
- d. Tighten the two ejection lever captive screws to secure the board.

FIGURE 3 Installing a SIM Board

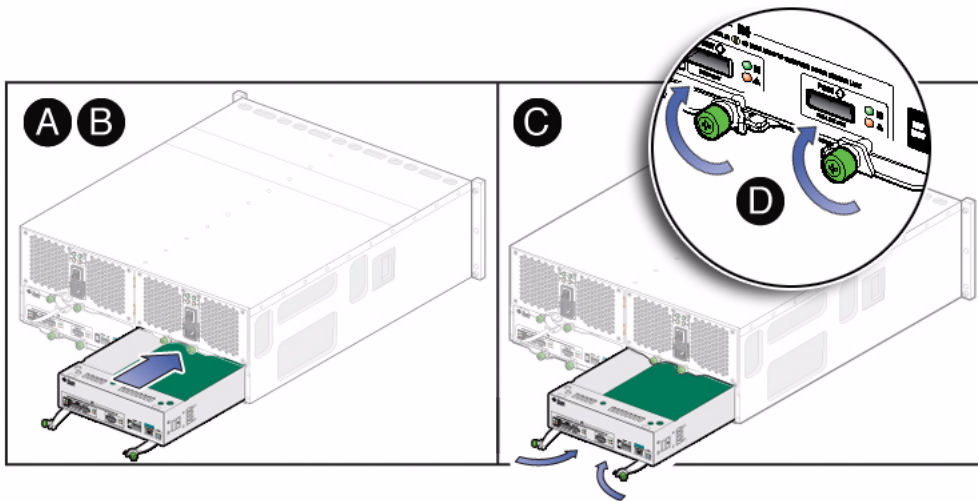

4. Reconnect the mini-SAS cables to their original locations.

▼ To Verify the SIM Board Replacement

- Wait approximately 60 seconds for the SIM board to complete its boot process, at which point ensure that the SIM board OK LED is lit green.

Documentation and Support

These web sites provide additional resources:

- Documentation <http://docs.oracle.com/>
- Support <http://www.oracle.com/us/support/index.html>

Documentation Feedback

Submit comments about this document at:

<http://www.oracle.com/goto/docfeedback>

Include the title and part number of your document with your feedback:

Sun Disk Shelf-24x3.5" SAS-2 SIM Board Replacement Guide,
part number 820-7244-12

