

Sun StorageTek™ 5320 NAS Appliance

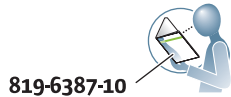

Contents

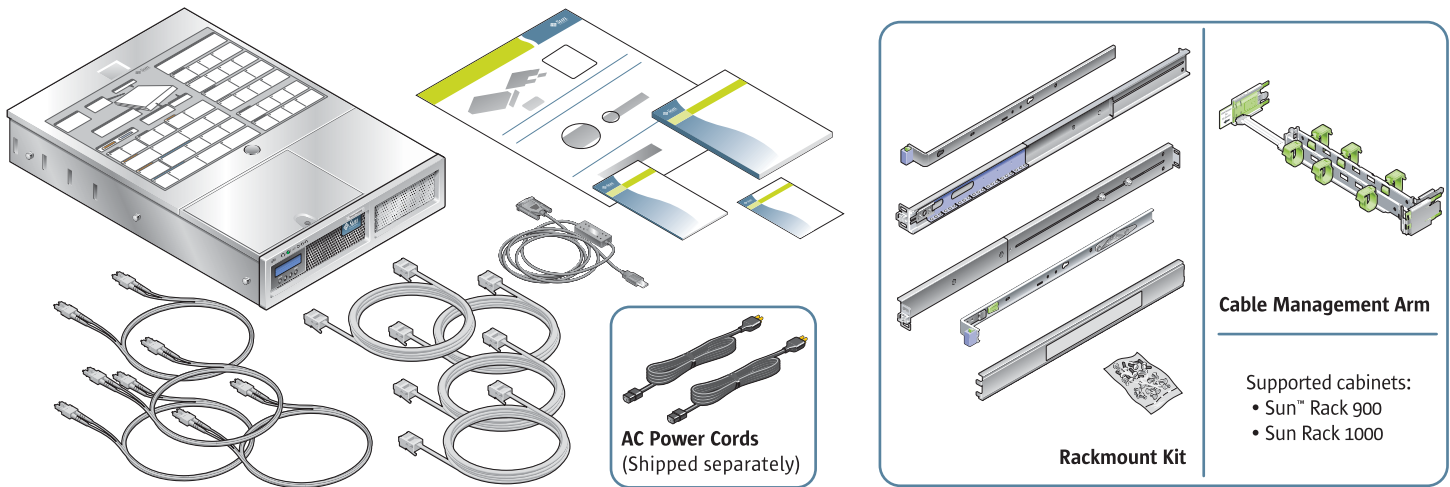

See the *Sun StorageTek 5320 NAS Appliance and Gateway System Getting Started Guide* for more information about optional equipment, setup instructions, and power-on procedures.

Documentation: http://www.sun.com/hwdocs/Network_Storage_Solutions/nas

Front Panel Controls

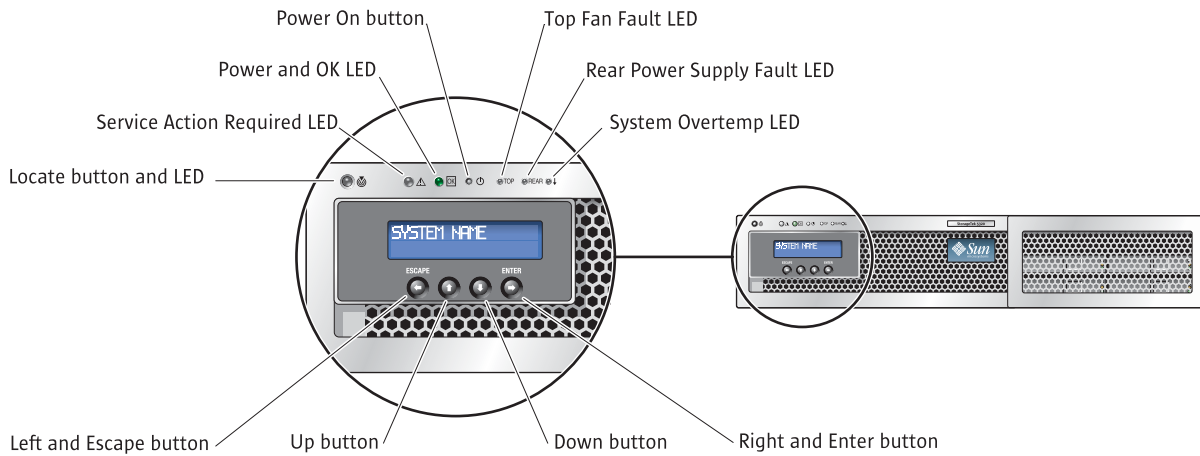

Back Panel

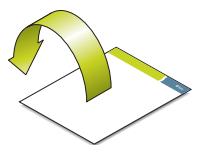
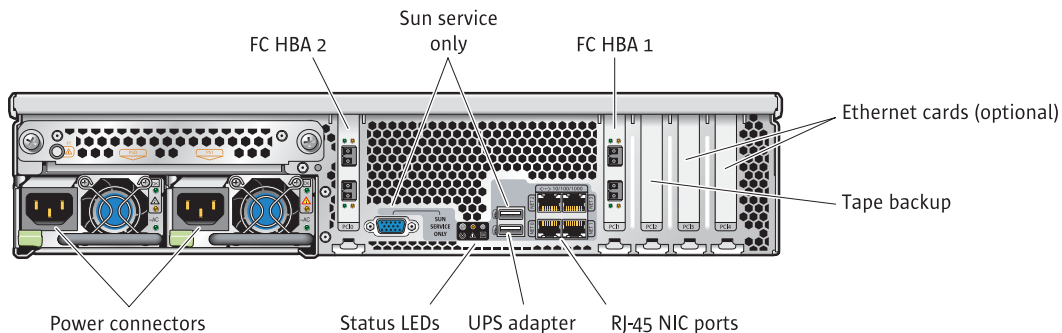

Configurations

• Single Server with Storage

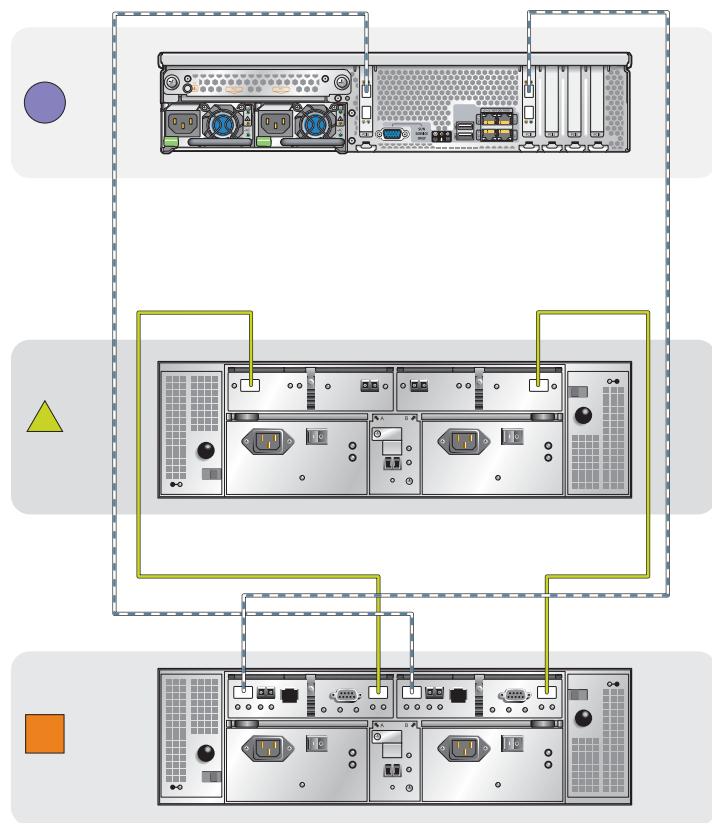

• Cluster with Storage

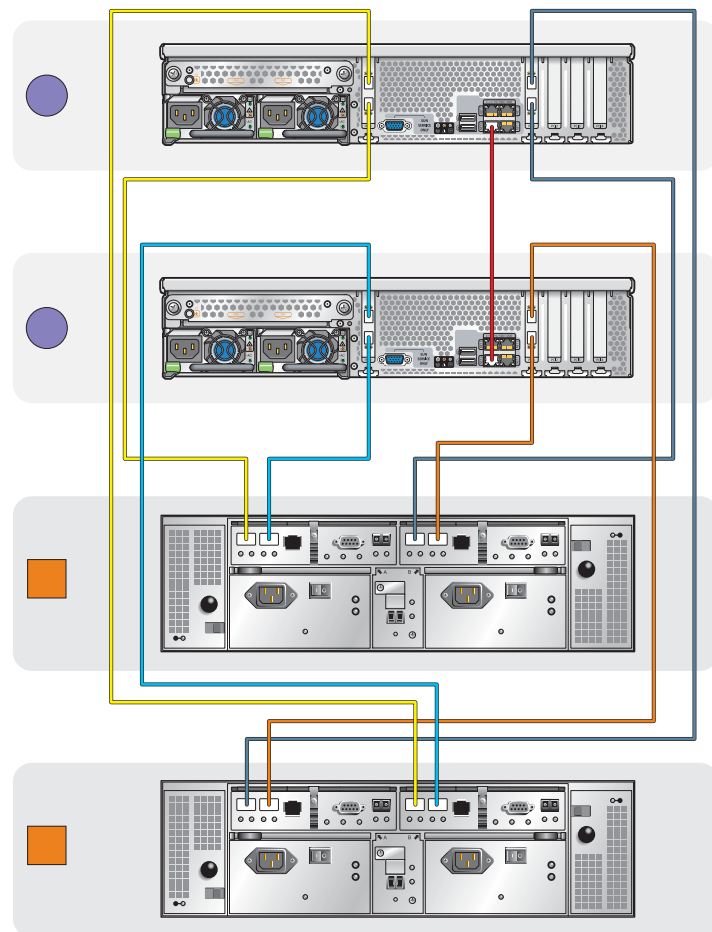

● NAS server

■ Controller unit

▲ Expansion unit

Setup and Power-On Procedures

819-6387-10



See the *Sun StorageTek 5320 NAS Appliance and Gateway System Getting Started Guide* for setup instructions and power-on procedures.

http://www.sun.com/hwdocs/Network_Storage_Solutions/nas